

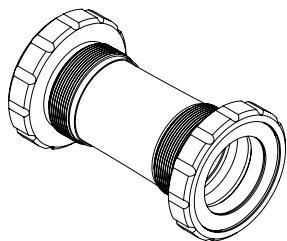

BSA Road TO FSA 386EVO THREADED BB System

TRIPEAK Product NO.
EMA-IB30-FS★TF12



Bearing Options

★ S (Steel Bearing) / ★ C (Ceramic Bearing)

● Bearing Size : 30 X 42 X 7mm (6806-2RS)

Replacement Bearing set

TRIPEAK item NO. S : EMA-HP6806-2RS / C : EMA-JC6806-2RS

Outer
Seal Cover

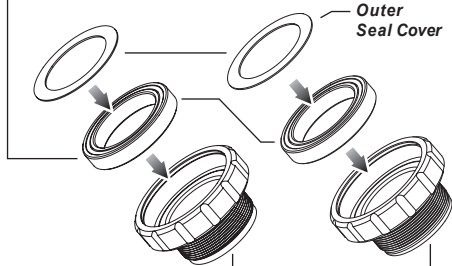

Non-Drive Side

Drive Side

Step 1

THREADED (TWIST-LOCK)

DRIVE SIDE Cup set lock to 30Nm

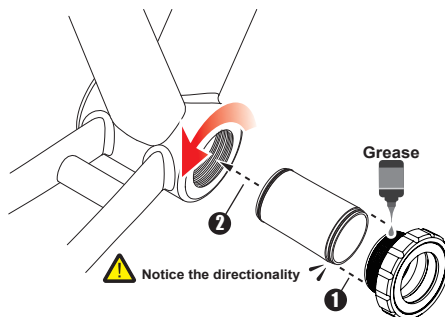

Step 2

THREADED (TWIST-LOCK)

Non-DRIVE SIDE Cup set lock to 30Nm

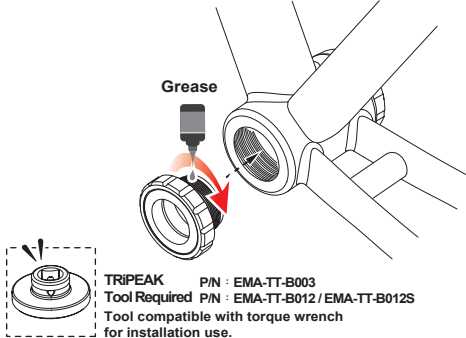

TRIPEAK P/N : EMA-TT-B003
Tool Required P/N : EMA-TT-B012 / EMA-TT-B012S
Tool compatible with torque wrench
for installation use.

⚠ NOTICE

- To install TRIPEAK Bottom Bracket, we strongly recommend that you have a trained bicycle mechanic at your local bike shop.
- Do not alter this product in any way as it can cause unseen damage. Any modifications to this product will void the warranty.
- Make sure with the crankset are firmly attached to the bottom bracket. Improperly attached cranks can become detached from the BB set.
- When cleaning the bottom bracket set, only use mild soap and water. Never spray with high-pressure water. It will cause BB cup internal water ingress and influencing the bearing rolling lifetime.
- If you have any questions or concerns about this product Please feel free to contact us. E-mail: info@tripeakbearing.com

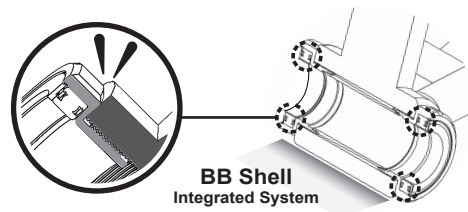

Installed-Width

